

SITE DEVELOPMENT PLAN PERRY STREET SOCIAL DISTRICT

LOT 4A, BLOCK 11 OF THE TOWN OF CASTLE ROCK
LOCATED IN THE NORTHEAST QUARTER OF SECTION 11, TOWNSHIP 8 SOUTH, RANGE 67 WEST OF THE 6TH P.M.
TOWN OF CASTLE ROCK, COUNTY OF DOUGLAS, STATE OF COLORADO
SDP21-0046

SITE PLAN LEGEND

	PROPERTY BOUNDARY
	PROPOSED EASEMENT
	REQUIRED BUILDING SETBACK
	PROPOSED BUILDING OUTLINE
	EXISTING CURB AND GUTTER
	PROPOSED CURB AND GUTTER
	DENOTES ADA ROUTE
	PARKING COUNT
	PROPOSED CONCRETE PAVEMENT
	PROPOSED SITE LIGHTING

GENERAL NOTES:

1. THE PROJECT SITE IS NOT WITHIN A WETLAND BOUNDARY.
2. ALL EXISTING UTILITIES AND SITE FEATURES TO REMAIN UNLESS OTHERWISE NOTED. SEE UTILITY SHEET FOR LOCATION.
3. SIGNS AND ACCESSORY STRUCTURES ARE SUBJECT TO REVIEWS AND PERMITS.
4. REFER TO SHEET A1 FOR NET FLOOR AREA OF THE PROPOSED USES.
5. ALL FEATURES IN SITE SCHEDULE ARE PROPOSED UNLESS NOTED OTHERWISE.

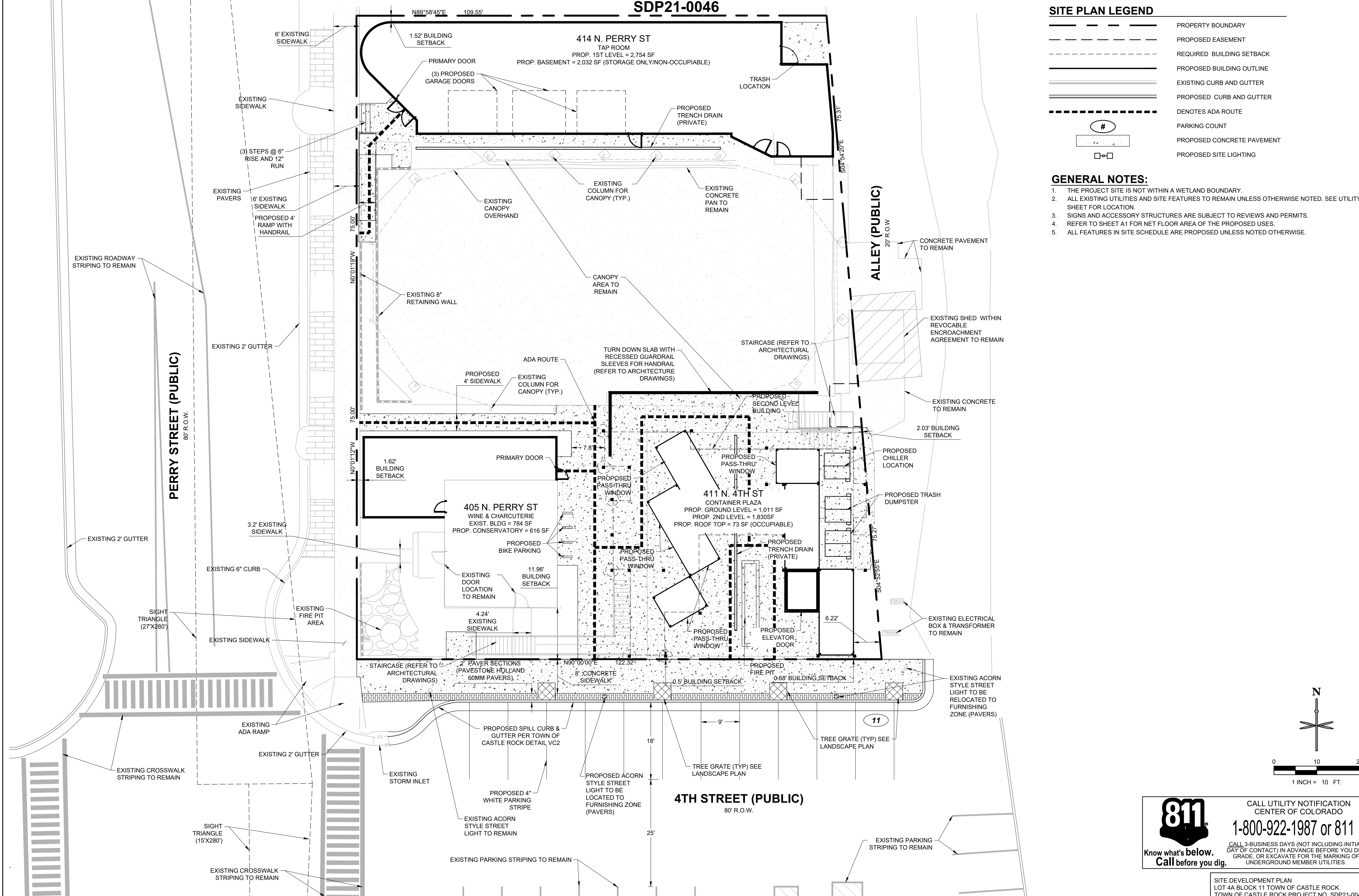

DATE	BY	REVISION

**PRELIMINARY
NOT FOR
CONSTRUCTION**

EES
ENTITLEMENT AND
PLANNING
SOLUTIONS, INC.
501 S Cherry St, Suite 300
Denver, CO 80246
303-572-7997 www.ees.us.com

SITE DEVELOPMENT PLAN
PERRY STREET SOCIAL DISTRICT
410 PERRY STREET, CASTLE ROCK, CO 80104
SITE PLAN

PROJECT NO.:	PER001.01
DESIGNED BY:	KMH
DRAWN BY:	KMH
DATE:	09/12/2022
3	SHEET 3 OF 12

811
Know what's below.
Call before you dig.

CALL UTILITY NOTIFICATION
CENTER OF COLORADO
1-800-922-1987 or 811
CALL 3-BUSINESS DAYS (NOT INCLUDING INITIAL DAY OF CONTACT) IN ADVANCE BEFORE YOU DIG. GRADE, OR EXCAVATE FOR THE MARKING OF UNDERGROUND MEMBER UTILITIES.

SITE DEVELOPMENT PLAN
LOT 4A BLOCK 11 TOWN OF CASTLE ROCK
TOWN OF CASTLE ROCK PROJECT NO. SDP21-0046

© 2022. ALL RIGHTS RESERVED. 9/27/2022 3:04 PM P:\PERRY STREET SOCIAL DISTRICT\CO. CASTLE ROCK - PERRY STREET SOCIAL (LTH & PERRY)08 CADSDP11.0 SITE PLAN.DWG